



The Landing Phase II

TBD Varney Lane, Pasco/Franklin County
MLS #278361, 278362, 278363, 278364, 278365, 278366

Contact

Kirt Shaffer | 509.521.9183
kirt@tippettcompany.com



SUMMARY

Available fall of 2025.

This office/retail strip center located in Pasco, WA at the entrance to the new Tri-Cities Airport Business Center. This prime location on the corner of the lighted intersection of Varney Lane and Argent Road.

The Tri-Cities Airport Business Center is an 86-acres business park strategically located near the entrances of both the Tri-Cities Airport and Columbia Basin Community College. Easy access to both freeways (I-182 and US-395).

The Business Center is designed for commercial office buildings, retail and hospitality. The Business Center is supported by 7,000 Columbia Basin College students, a growing residential population and existing businesses including Washington's 3rd largest airport (Tri-Cities Airport) serving over 800,000 passengers annually.

LEASE PRICE \$29.00/RSF + NNN

Suite 100	–	1,904.11 RSF
Suite 101	–	1,337.93 RSF
Suite 102	–	1,409.94 RSF
Suite 103	–	1,409.94 RSF
Suite 104	–	1,479.80 RSF
Suite 105	–	1,763.90 RSF

ADDRESS

TBD Varney Lane, Ste 100 - 105,
Pasco, WA 99301

TAX PARCELS

117-010-010 and 119-180-011

CONTACT

Kirt Shaffer
Office 509.545.3355
Mobile 509.521.9183
kirt@tippettcompany.com
2815 St, Andrews Loop, Suite F
Pasco, WA 99301

TRI-CITIES AIRPORT BUSINESS CENTER



https://www.portofpasco.org/uploads/properties/PoP_AirportMarketing_Brochure_Digital.pdf

No warranty or representation, expressed or implied, is made as to the accuracy of information contained herein, and same is submitted subject to errors, omission, change of price, rental or other conditions and withdrawal without notice. Purchaser and his/her agent are responsible for independently verifying all presented information.

AREA DEMOGRAPHICS

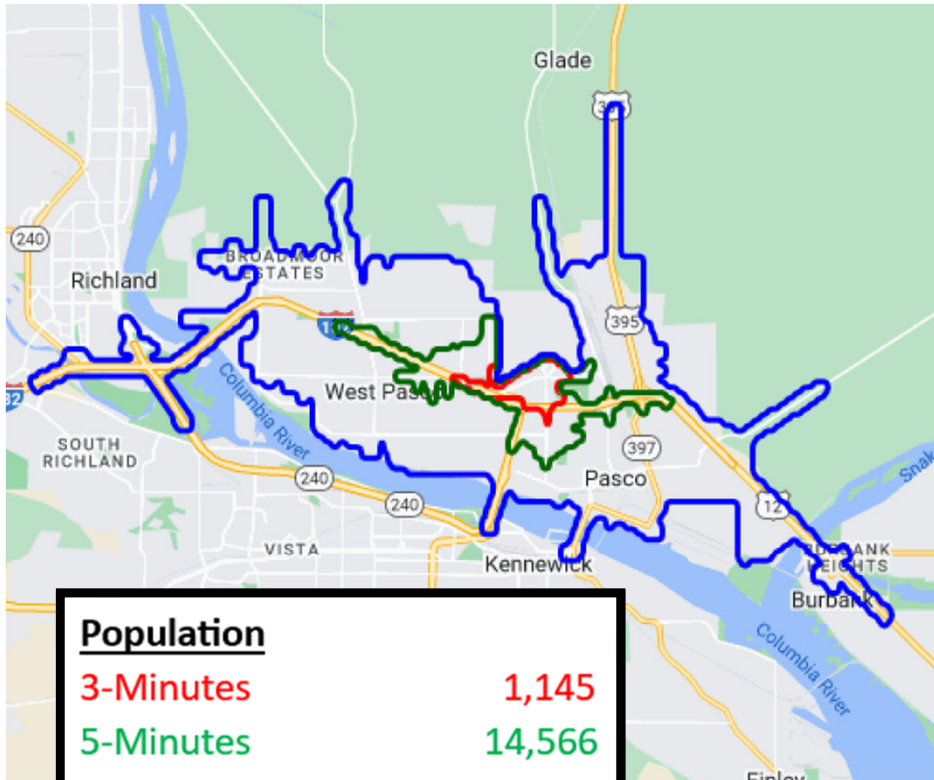

<u>Population</u>	
3-Minutes	1,145
5-Minutes	14,566
10-Minutes	78,401
<u>Avg. Household Income</u>	
3-Minutes	\$53,507.81
5-Minutes	\$57,858.93
10-Minutes	\$58,677.50

TRAFFIC COUNTS

10,000 Trips per day on Argent

(Est. by PBS Engineering based on recent traffic study)

UTILITIES

Power – Franklin PUD

Water & Sewer – City of Pasco

LINKS

Municipal

<https://www.pasco-wa.gov/>

<https://www.franklincountywa.gov/>

Economic Development

<https://www.portofpasco.org/>

<https://www.tridec.org/>

CITY DEMOGRAPHICS

Demographics are determined by a 10 minute drive from 0 Varney Lane, Pasco, WA 99301

CITY, STATE

Pasco, WA

POPULATION

78,401

AVG. HH SIZE

2.94

MEDIAN HH INCOME

\$52,062

HOME OWNERSHIP

Renters: **7,539**

Owners: **16,241**

EMPLOYMENT

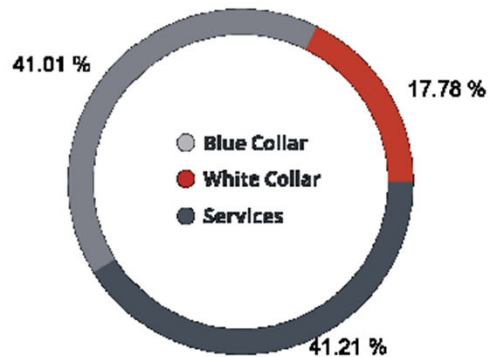

40.95 %
Employed

1.69 %
Unemployed

EDUCATION

High School Grad: **23.30 %**
Some College: **19.19 %**
Associates: **7.96 %**
Bachelors: **22.21 %**

GENDER & AGE

50.46 %   **49.54 %**

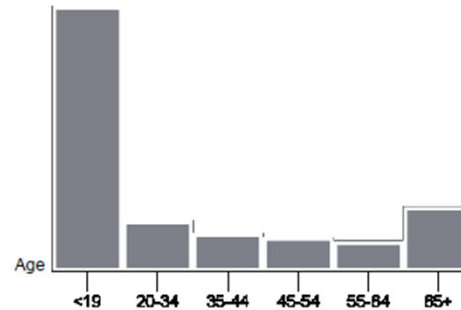

RACE & ETHNICITY

White: **30.14 %**
Asian: **0.36 %**
Native American: **0.14 %**
Pacific Islanders: **0.02 %**
African-American: **0.58 %**
Hispanic: **40.58 %**
Two or More Races: **28.18 %**

INCOME BY HOUSEHOLD

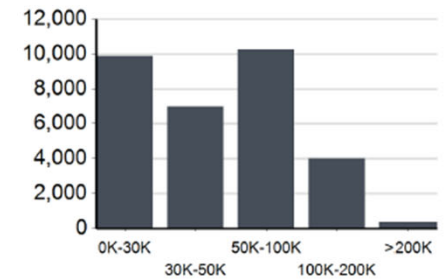

HH SPENDING

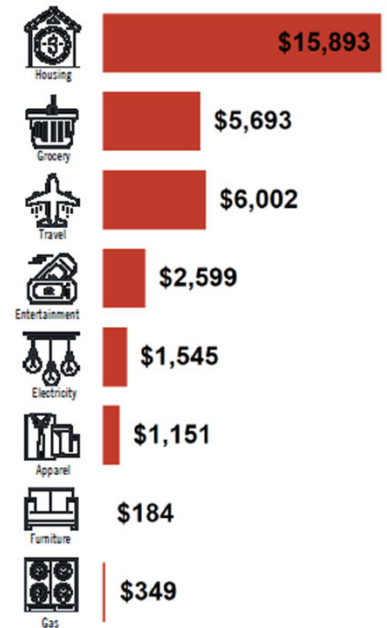

No warranty or representation, expressed or implied, is made as to the accuracy of information contained herein, and same is submitted subject to errors, omission, change of price, rental or other conditions and withdrawal without notice. Purchaser and his/her agent are responsible for independently verifying all presented information.

LOCATION MAP

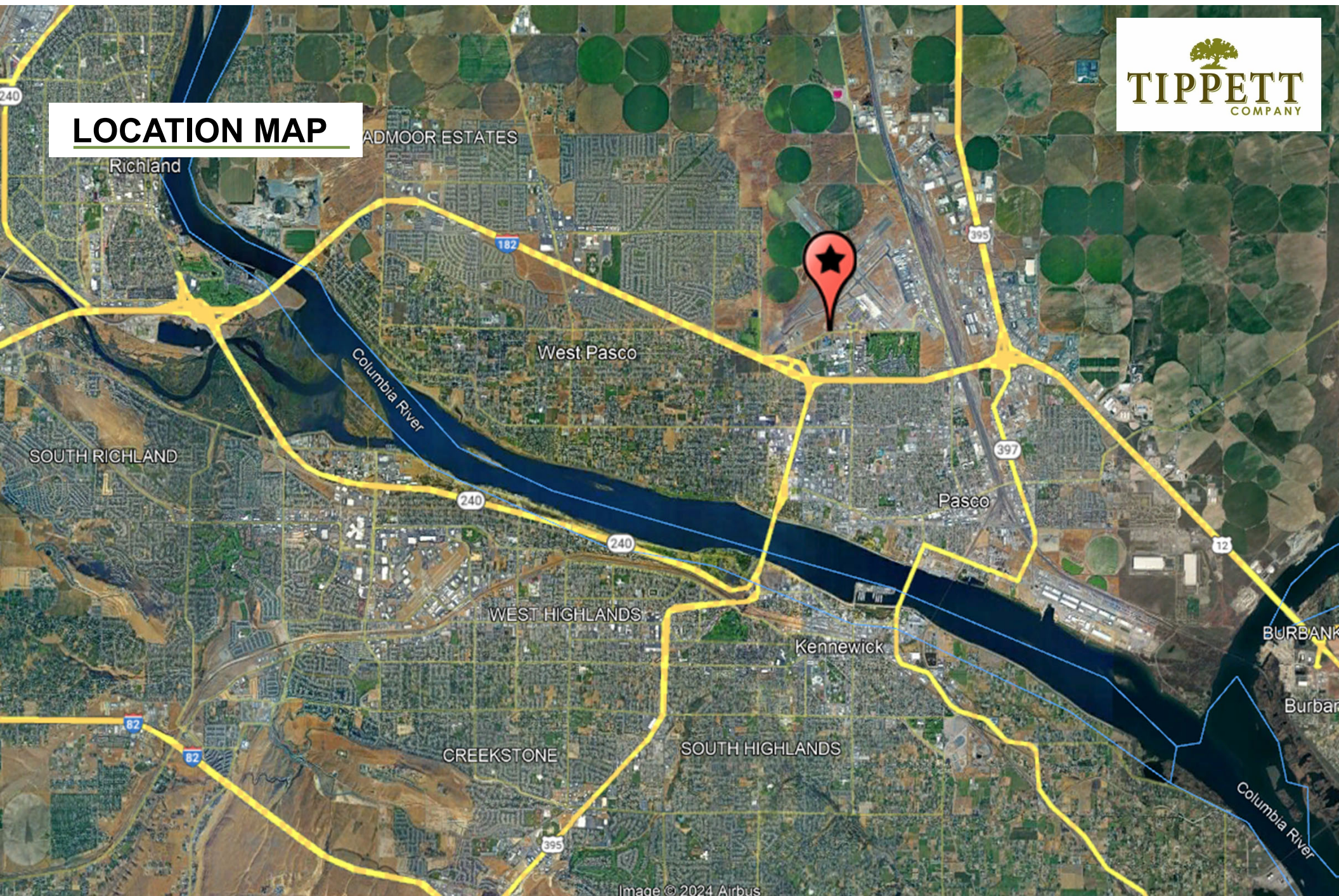

No warranty or representation, expressed or implied, is made as to the accuracy of information contained herein, and same is submitted subject to errors, omission, change of price, rental or other conditions and withdrawal without notice. Purchaser and his/her agent are responsible for independently verifying all presented information.

AREA BUSINESSES

No warranty or representation, expressed or implied, is made as to the accuracy of information contained herein, and same is submitted subject to errors, omission, change of price, rental or other conditions and withdrawal without notice. Purchaser and his/her agent are responsible for independently verifying all presented information.

SITE PLAN

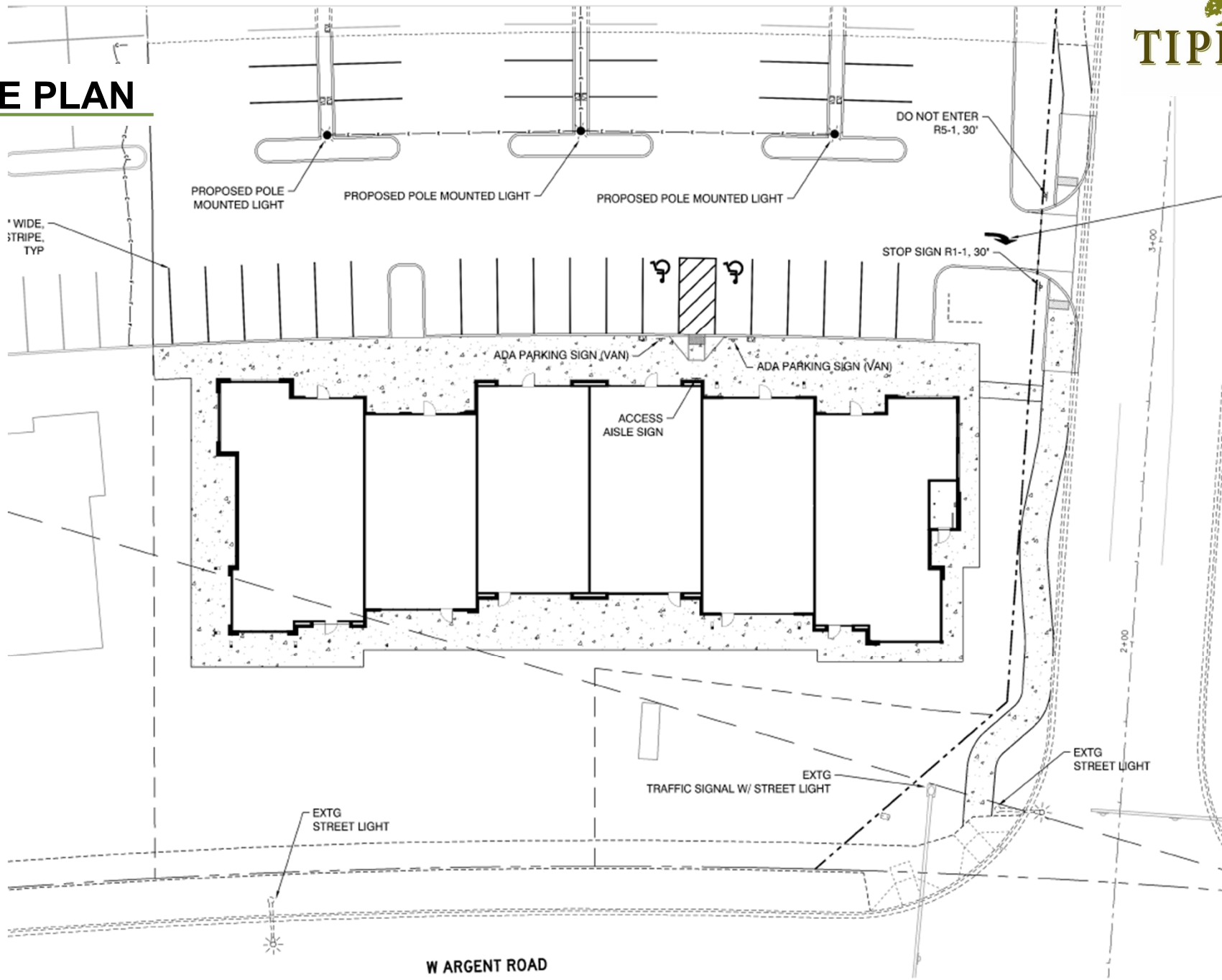

No warranty or representation, expressed or implied, is made as to the accuracy of information contained herein, and same is submitted subject to errors, omission, change of price, rental or other conditions and withdrawal without notice. Purchaser and his/her agent are responsible for independently verifying all presented information.

FLOOR PLAN

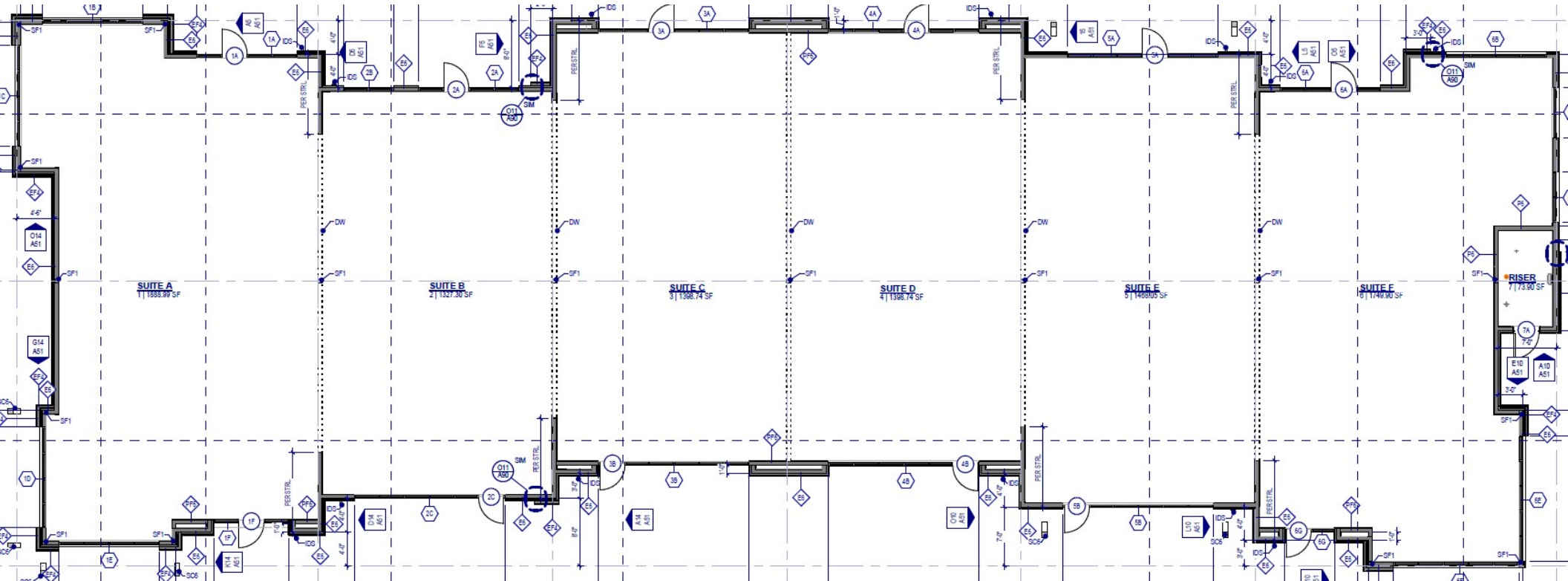

No warranty or representation, expressed or implied, is made as to the accuracy of information contained herein, and same is submitted subject to errors, omission, change of price, rental or other conditions and withdrawal without notice. Purchaser and his/her agent are responsible for independently verifying all presented information.

SCHEMATIC DRAWINGS



No warranty or representation, expressed or implied, is made as to the accuracy of information contained herein, and same is submitted subject to errors, omission, change of price, rental or other conditions and withdrawal without notice. Purchaser and his/her agent are responsible for independently verifying all presented information.